

# Assembly 3

Attach to top of engine

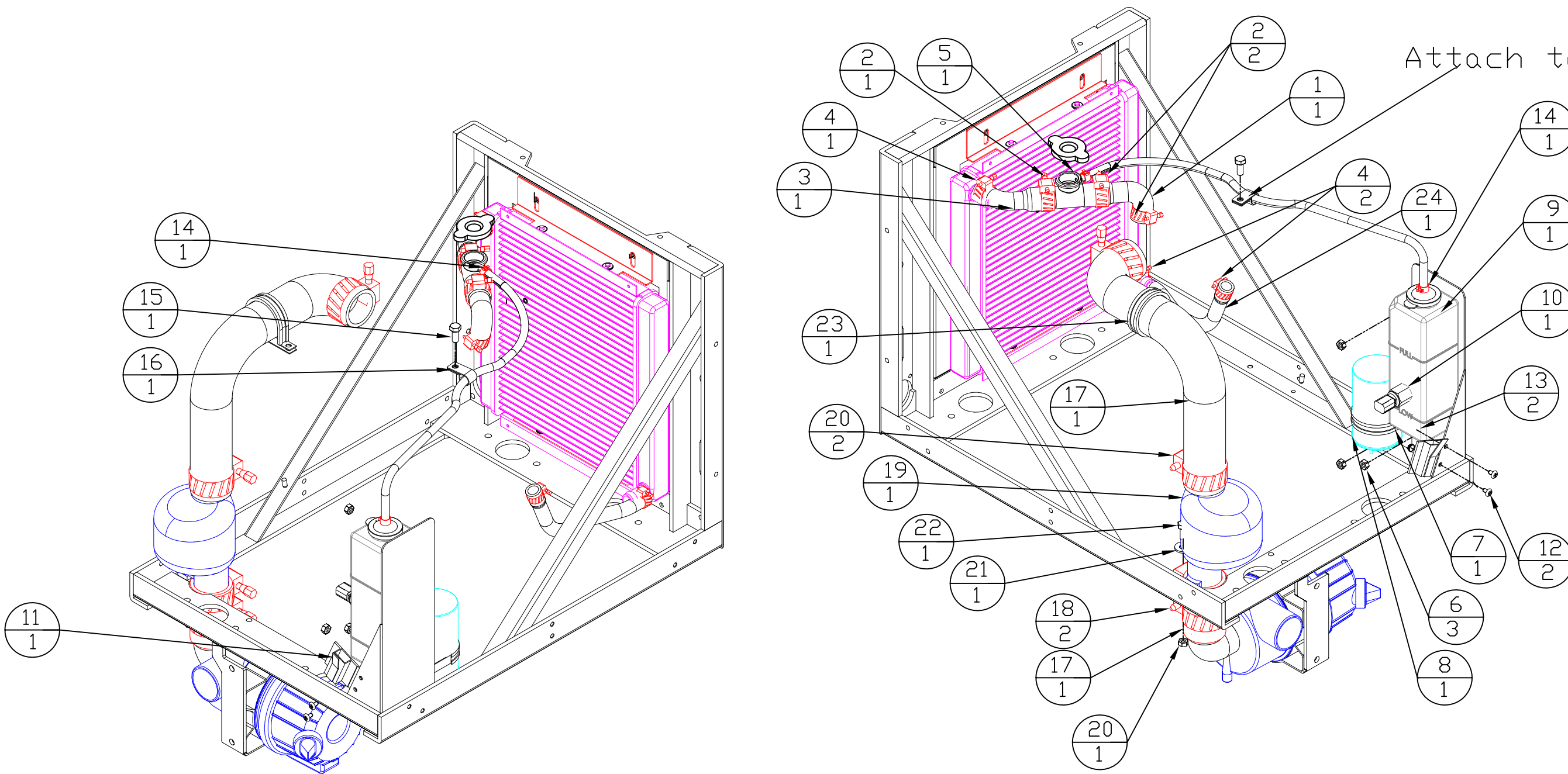

| KEY | QTY. | DESCRIPTION            | PART NO.  | Unit Conv. |
|-----|------|------------------------|-----------|------------|
| 25  | 1    | Radiator fill cap      | 54-8171-A |            |
| 24  | 1    | Lower rad. hose        | 56-0006   |            |
| 23  | 1    | Clamp                  | 56-0011   |            |
| 22  | 1    | Bolt                   | 54-8345   |            |
| 21  | 1    | Washer                 | 54-8312   |            |
| 20  | 1    | Nut                    | 54-8345   |            |
| 19  | 1    | Air intake resonator   | 54-8581   |            |
| 18  | 4    | Hose clamps            | 54-8131   |            |
| 17  | 1    | Air intake hose        | 56-0009   |            |
| 16  | 1    | Clamp                  | 54-8137   |            |
| 15  | 1    | Bolt                   | 2672      |            |
| 14  | 2    | Clamp                  | 54-8088   |            |
| 13  | 2    | Nut                    | 54-8332   |            |
| 12  | 2    | Bolt                   | 54-8331   |            |
| 11  | 1    | Safety door switch     | 54-8006   |            |
| 10  | 1    | Coolant sensor         | 54-8065   |            |
| 9   | 1    | Coolant bottle         | 54-8091-D |            |
| 8   | 1    | Capacitor              | 56-152523 |            |
| 7   | 1    | Capacitor clamp        | 56-0021   |            |
| 6   | 3    | Nuts                   | 54-8345   |            |
| 5   | 1    | Overflow coupler       | 54-8040   |            |
| 4   | 3    | Hose clamps            | 54-8129   |            |
| 3   | 1    | Upper radiator hose #2 | 56-0008   |            |
| 2   | 3    | Hose clamps            | 54-8483   |            |
| 1   | 1    | Upper radiator hose #1 | 56-0007   |            |

| KEY  | QTY. | DESCRIPTION | PART NO. | Unit Conv. |
|--|------|-------------|----------|------------|
| <p><b>dynasys</b> confidential property of <b>PERRIN MANUFACTURING INC.</b> ALLIANCE, NEBRASKA</p> <p>dr. <u>BN</u> 10/11/16</p> <p>1 place dec. ± .06"<br/>2 place dec. ± .032"<br/>3 place dec. ± .016"<br/>angular ± 1°</p> <p>Title: <b>APU ASSY. ASSY. 3</b></p> <p>Engr. Ref. <b>DYNASYS</b> Part No. <b>57-1000</b></p> <p>Price code <b>SC</b> Sheet <b>1 of 1</b></p> |      |             |          |            |